

VRF (Variable Refrigerant Flow) User manual

VWMD****6-5P

- Thank you for purchasing this Lennox Product.
- Before operating this unit, please read this manual carefully and retain it for future reference.



Contents

Safety Information	4
Safety Information	4
At a Glance	14
Indoor Unit Overview	14
Display	14
Cleaning and Maintenance	15
Cleaning	15
Maintaining the Product	18
Internal protections via the unit control system	19
Appendix	20
Troubleshooting	20
Operation Ranges	21

Safety Information

California Proposition 65 Warning (US)

 **WARNING:** Cancer and Reproductive Harm - www.P65Warnings.ca.gov.

Before using your new air conditioner, please read this manual thoroughly to ensure that you know how to operate the extensive features and functions of your new appliance safely and efficiently.

Because the following operating instructions cover various models, the characteristics of your air conditioner may differ slightly from those described in this manual. If you have any questions, call your nearest contact center or find help and information online at www.Lennoxhvac.com

ENERGY STAR qualified model only

Proper sizing and installation of equipment is critical to achieve optimal performance. Split system air conditioners and heat pumps (excluding ductless systems) must be matched with appropriate coil components to meet ENERGY STAR criteria. Ask your contractor for details or visit www.energystar.gov.



WARNING







Hazards or unsafe practices that may result in severe personal injury or death.

CAUTION

Hazards or unsafe practices that may result in minor personal injury or property damage.

Safety Information

- ❗ Follow directions.
- ⊘ Do NOT attempt.
- ⚡ Make sure the machine is grounded to prevent electric shock.
- 🔌 Cut off the power supply.
- ⊘ Do NOT disassemble.

Symbol	Meaning
	Flammable gas
	Flammable materials
	Refrigerant safety group
	Read operating manual
	Refer to operating manual
	Read service manual

FOR INSTALLATION



WARNING

- ❗ Use the power line with the power specifications of the product or higher and use the power line for this appliance only. In addition, do not use an extension line.

- Extending the power line may result in electric shock or fire.
- Do not use an electric transformer. This may result in electric shock or fire.
- If the voltage/frequency/rated current condition is different, it may cause a fire.

The installation of this appliance must be performed by a qualified technician or service company.

- Failing to do so may result in electric shock, fire, explosion, problems with the product, or injury.

Install a switch and a circuit breaker dedicated to the air conditioner.

- Failing to do so may result in electric shock or fire.

Fix the outdoor unit firmly so that the electric part of the outdoor unit is not exposed.

- Failing to do so may result in electric shock or fire.

- ⊘ **Do not install this appliance near a heater, or flammable material. Do not install this appliance in a humid, oily or dusty location, in a location exposed to direct sunlight and water (rain drops). Do not install this appliance in a location where gas may leak.**

- This may result in electric shock or fire.

Never install the outdoor unit in a location such as on a high external wall where it could fall.

- If the outdoor unit falls, it may result in injury, death or property damage.

Safety Information

-  This appliance must be properly grounded. Do not ground the appliance to a gas pipe, plastic water pipe, or telephone line.
 - Failure to do so may result in electric shock, fire, an explosion, or other problems with the product.



CAUTION

-  Install your appliance on a level and hard floor that can support its weight.
 - Failing to do so may result in abnormal vibrations, noise, or problems with the product.

Install the drain hose properly so that the water is drained correctly.

- Failing to do so may result in water overflowing and property damage. Avoid adding drains to waste pipes as odors may arise in the future.

When installing the outdoor unit, make sure to connect the drain hose so that draining is performed correctly.

- The water generated during the heating operation in the outdoor unit may overflow and result in property damage. In winter, if a block of ice falls, it may result in injury, death or property damage.

The product shall be stored in a room with no ignition sources (e.g. open flames, gas appliance, electric heater, etc.).

- Note that the refrigerant has no odor.

FOR POWER SUPPLY



WARNING

-  When the circuit breaker is damaged, contact your nearest service center.

- ⊗ Do not pull or excessively bend the power line. Do not twist or tie the power line. Do not hook the power line over a metal object, place a heavy object on the power line, insert the power line between objects, or push the power line into the space behind the appliance.

- This may result in electric shock or fire.



CAUTION



When not using the air conditioner for a long time or during a thunder/lightning storm, cut the power at the circuit breaker.

- Failing to do so may result in electric shock or fire.

FOR USING



WARNING



If the appliance is flooded, please contact your nearest service center.

- Failing to do so may result in electric shock or fire.

If the appliance generates a strange noise, a burning smell or smoke, cut off the power supply immediately and contact the nearest service center.

- Failing to do so may result in electric shock or fire.

In case of a malfunction, immediately stop operation of the air conditioner and disconnect the entire power system. Then consult the authorized service personnel.

In the event of a gas leak (such as propane gas, LP gas, etc.), ventilate immediately without touching the power line. Do not touch the appliance or power line.

- Do not use a ventilating fan.
- A spark may result in an explosion or fire.



Safety Information

To reinstall the air conditioner, please contact your nearest service center.

- Failing to do so may result in problems with the product, water leakage, electric shock, or fire.
- A delivery service for the product is not provided. If you reinstall the product in another location, additional construction expenses and an installation fee will be charged.
- Especially, when you wish to install the product in an unusual location such as in an industrial area or near the seaside where it is exposed to salt in the air, please contact your nearest service center.



Do not touch the circuit breaker with wet hands.

- This may result in electric shock.

Do not turn the air conditioner off with the circuit breaker while it is operating.

- Turning the air conditioner off and then on again with the circuit breaker may cause a spark and result in electric shock or fire.

After unpacking the air conditioner, keep all packaging materials well out of the reach of children, as packaging materials can be dangerous to children.

- If a child places a bag over its head, it may result in suffocation.

Do not touch the front panel with your hands or fingers during the heating operation.

- This may result in electric shock or burns.

Do not insert your fingers or foreign substances into the outlet when the air conditioner is operating or the front panel is closing.

- Take special care that children do not injure themselves by inserting their fingers into the product.



Do not insert your fingers or foreign substances into the air inlet/outlet of the air conditioner.

- Take special care that children do not injure themselves by inserting their fingers into the product.

Do not strike or pull the air conditioner with excessive force.

- This may result in fire, injury, or problems with the product.

Do not place an object near the outdoor unit that allows children to climb onto the machine.

- This may result in children seriously injuring themselves.

Do not use this air conditioner for long periods in badly ventilated locations or near infirm people.

- Since this may be dangerous due to a lack of oxygen, open a window at least once an hour.

Do not use means to accelerate the defrost operation or to clean, other than those recommended by Lennox.

Do not pierce or burn.

Be aware that refrigerants may not contain an odor.

- ⚠ **If any foreign substance such as water has entered the appliance, cut off the power supply and contact the nearest service center.**

- Failing to do so may result in electric shock or fire.

- ⚠ **Do not attempt to repair, disassemble, or modify the appliance yourself.**

- Do not use any fuse (such as copper, steel wire, etc.) other than the standard fuse.
- Failing to do so may result in electric shock, fire, problems with the product, or injury.



Safety Information



CAUTION



Do not place objects or devices under the indoor unit.

- Water dripping from the indoor unit may result in fire or property damage.

Check that the installation frame of the outdoor unit is not broken at least once a year.

- Failing to do so may result in injury, death or property damage.

When the air conditioner does not operate properly for cooling or heating, there is a possibility of refrigerant leakage. If any leakage, stop operation, ventilate the room, and consult your dealer to recharge the refrigerant.

The refrigerant is not harmful. However, if it comes in contact with fire, it may generate harmful gases and there is a risk of fire.

During the transportation of the indoor unit, the pipelines shall be covered with brackets for protection. Do not move the product by holding the refrigerant or drain pipe connections.

- It may cause gas leakage.

Do not install the product on a ship or a vehicle (such as a campervan).

- Salt, vibration or other environmental factors may cause the product to malfunction, electric shock or fire.



Do not stand on top of the appliance or place objects (such as laundry, lighted candles, lighted cigarettes, dishes, chemicals, metal objects, etc.) on the appliance.

- This may result in electric shock, fire, problems with the product, or injury.

Do not operate the appliance with wet hands.

- This may result in electric shock.



Do not spray volatile material such as insecticide onto the surface of the appliance.

- As well as being harmful to humans, it may also result in electric shock, fire or problems with the product.

Do not drink the water from the air conditioner.

- The water may be harmful to humans.

Do not apply a strong impact to the remote controller and do not disassemble the remote controller.

Do not touch the pipes connected to the product.

- This may result in burns or injury.

Do not cut or burn the refrigerant container or piping.

Do not point the air direction to a fireplace or heater.

Do not use this air conditioner to preserve precision equipment, food, animals, plants or cosmetics, or for any other unusual purposes.

- This may result in property damage.

Avoid directly exposing humans, animals or plants to the air flow from the air conditioner for long periods.

- This may result in harm to humans, animals or plants.

This appliance is not intended for use by persons (including children) with reduced physical, sensory or mental capabilities, or lack of experience and knowledge, unless they have been given supervision or instruction concerning the use of the appliance by a person responsible for their safety. Children should be supervised to ensure that they do not play with the appliance.

FOR CLEANING

WARNING

- ⊘ Do not clean the appliance by spraying water directly onto it. Do not use benzene, thinner, alcohol or acetone to clean the appliance.
 - This may result in discoloration, deformation, damage, electric shock or fire.

Before cleaning or performing maintenance, cut off the power supply and wait until the fan stops.

- Failing to do so may result in electric shock or fire.

CAUTION

- ⊘ Take care when cleaning the surface of the heat exchanger of the outdoor unit since it has sharp edges.
 - To avoid cutting your fingers, wear thick cotton gloves when cleaning it.
 - This should be done by a qualified technician. Please contact your installer or service center.
- ⊘ **Do not clean the inside of the air conditioner by yourself.**
 - For cleaning inside the appliance, contact your nearest service center.
 - When cleaning the internal filter, refer to the descriptions in the 'Cleaning and Maintaining' section.
 - Failure to do so may result in damage, electric shock or fire.
 - Make sure to prevent any injury from sharp edges of the surface when handling the heat exchanger.

Indoor Unit Overview

The appearance of the actual product may differ slightly from the image below.

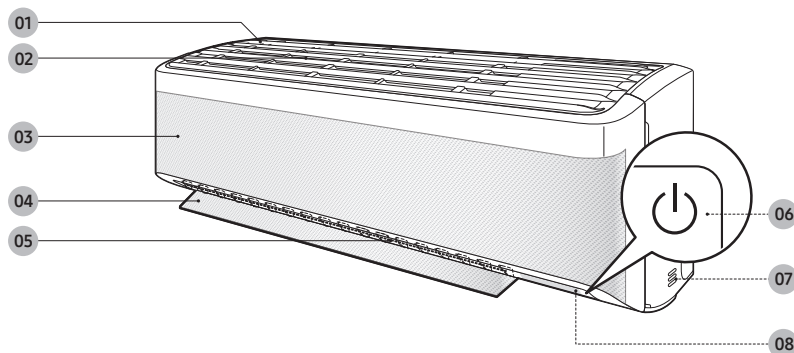

- | | |
|--------------------------------|---|
| 01 Air intake | 05 Airflow blade (left and right) |
| 02 Air filter | 06 Power button/Remote control receiver |
| 03 Panel | 07 Room temperature sensor |
| 04 Airflow blade (up and down) | 08 Display |

Display

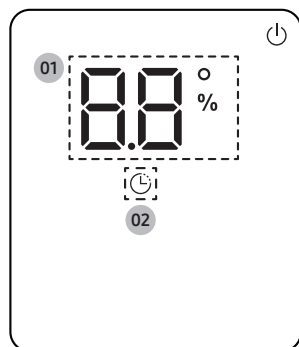

- | | |
|----|---------------------------------|
| 01 | Temperature indicator (numeric) |
| | Filter reset indicator (⏏ F) |
| | Auto clean indicator (⏏ i) |
| | Defrost indicator (dF) |
| 02 | Timer indicator |
| | good'sleep indicator |

Cleaning

Cleaning the outside of the indoor unit

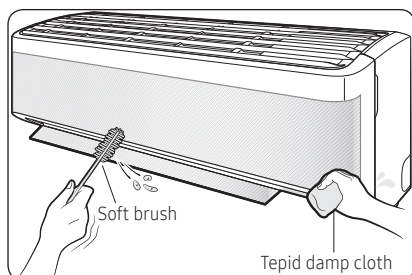

- 1 Turn off the Product and wait until the fan stops.
- 2 Disconnect the power supply.
- 3 Use a soft brush or tepid damp cloth to clean the exterior.



WARNING

- Do not clean the appliance by spraying water directly onto it. Water entering the unit may result in electric shock or fire that could cause death, serious injury, or property damage:



CAUTION

- Do not use an alkaline detergent to clean the indoor unit display.
- Do not use sulphuric acid, hydrochloric acid, or organic solvents such as paint thinner, kerosene, acetone, benzene, or alcohol to clean the unit surfaces.

Cleaning the filter

Clean the air filter every two weeks or when the **CF** (filter-cleaning reminder) appears on the indoor unit display. The time between cleanings may vary, depending on the usage and environmental conditions.

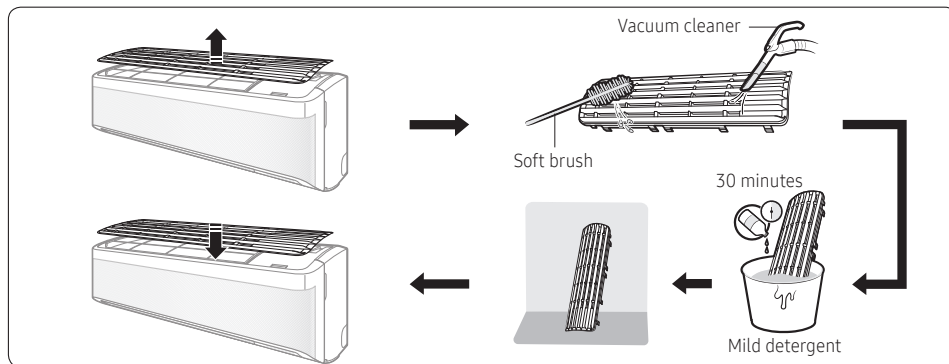

- 1 Slide the filter off of the unit.
- 2 Use a soft brush or vacuum cleaner to remove any dust or debris on the filter.
- 3 Soak the filter in a solution of water and mild detergent for 30 minutes.
- 4 Rinse the filter and let it air dry in a well-ventilated area that is out of direct sunlight.
- 5 Reinstall the filter.
- 6 Reset the filter-cleaning reminder:

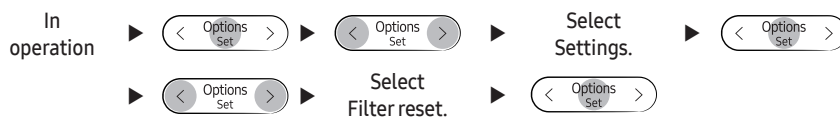

CAUTION

- Take care not to damage the filter during cleaning.
- Do not scrub the air filter with a hard-bristle brush or another cleaning utensil.
- Do not expose the air filter to direct sunlight when drying it.



Cleaning

Cleaning the panel

Clean the panel at least once a month.

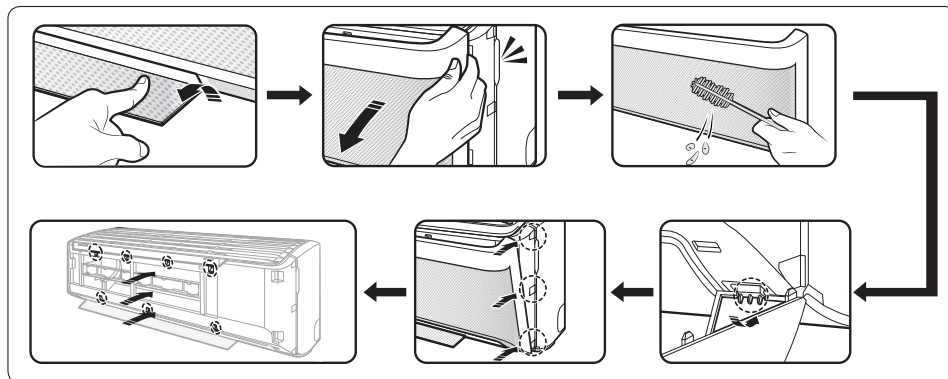

- 1 Pull the airflow blade open.
- 2 Hold and pull both sides of the panel until it comes free from the Product.
- 3 Use a soft brush or vacuum cleaner to remove any dust.
- 4 Hang the panel in the grooves at the bottom left and right.
- 5 Align the projections of the panel with the grooves at the top, middle, and bottom of the front panel.
- 6 After inserting the panel, press the top 4 places and the bottom 3 places by hand so that there is no gap to the panel.

CAUTION

- If you attach the panel without the airflow blade being open, it may become obstructed by the panel and may not open properly.



Maintaining the Product

If the Product will not be used for an extended period of time, dry the Product to maintain in best conditions.

- 1 Dry the Product thoroughly by operating in Fan mode for 3 to 4 hours and disconnect the power plug. There may be internal damage if moisture is left in components.
- 2 Before using the Product again, dry the inner components of the Product again by running in Fan mode for 3 to 4 hours. This helps remove odours that may have generated from dampness.

Periodical checks

Refer to the following chart to maintain the Product properly.

Type	Description	Monthly	Every 4 months	Once a year
Indoor unit	Clean the air filter (1).	●		
	Clean the condensate drain pan (2).			●
	Thoroughly clean the heat exchanger (2).			●
	Clean the condensate drain pipe (2).		●	
Outdoor unit	Clean the heat exchanger on the outside of the unit (2).		●	
	Clean the heat exchanger on the inside of the unit (2).			●
	Clean the electric components with jets of air (2).			●
	Verify that all the electric components are firmly tightened (2).			●
	Clean the fan (2).			●
	Verify that all the fan assembly is firmly tightened (2).			●
	Clean the condensate drain pan (2).			●

NOTE

- The checks and maintenance operations described above are essential to guarantee the efficiency of the Product. The frequency of these operations may vary depending on the characteristics of the area, the amount of dust, etc.
 - (1) The above mentioned operations should be performed more frequently if the area of installation is very dusty.
 - (2) These operations must always be performed by qualified personnel. For more detailed information, refer to Installation Manual.



Maintaining the Product

Internal protections via the unit control system

This internal protection operates if an internal fault occurs in the Product.

Type	Description
Against cold air	The internal fan will be off against cold air when the heat pump is heating.
De-ice cycle	The internal fan will be off against cold air when the heat pump is heating.
Protect compressor	The Product does not start operating immediately to protect the compressor of the outdoor unit after it has been started.





NOTE

- If the heat pump is operating in Heat mode, the de-ice cycle is actuated to remove frost from an outdoor unit that may have deposited at low temperatures.
- The internal fan is switched off automatically and restarted only after the de-ice cycle is completed.
- When the de-ice cycle is operating, it may generate strange sound. It is normal operation for product safety.

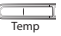

Troubleshooting

Refer to the following chart if the Product operates abnormally. This may save time and unnecessary expenses.

Problem	Solution
The Product does not operate immediately after it has been restarted.	<ul style="list-style-type: none"> Because of the protective mechanism, the appliance does not start operating immediately to keep the unit from overloading. The Product will start in 3 minutes.
The Product does not work at all.	<ul style="list-style-type: none"> Check that the power plug is properly connected. Insert the power plug into the wall socket correctly. Check if the circuit breaker is switched off. Check if there is a power failure. Check your fuse. Make sure it is not blown out.
The temperature does not change.	<ul style="list-style-type: none"> Check if you selected Fan mode. Press the  button on the remote control to select another mode.
The cool (or warm) air does not come out of the Product.	<ul style="list-style-type: none"> Check if the set temperature is higher (lower) than the current temperature. Press the  button on the remote control to change the set temperature. Press the Temperature  button to increase or decrease the temperature. Check if the air filter is blocked by dirt. Clean the air filter every two weeks. Check if the Product has just been turned on. If so, wait for 3 minutes.
The fan speed does not change.	<ul style="list-style-type: none"> Check if you selected Auto or Dry mode. The Product automatically adjusts the fan speed to Auto in Auto/Dry mode.
Timer function is not set.	<ul style="list-style-type: none"> Check if you press the  and  button on the remote control after you have set the time.
Odours permeate in the room during operation.	<ul style="list-style-type: none"> Check if the appliance is running in a smoky area or if there is a smell entering from outside. Operate the Product in Fan mode or open the windows to air out the room.
The Product makes a bubbling sound.	<ul style="list-style-type: none"> A bubbling sound may be heard when the refrigerant is circulating through the compressor. Let the Product operate in the selected mode.

Troubleshooting

Problem	Solution
Water is dripping from the air flow blades.	<ul style="list-style-type: none">• Check if the Product has been cooling for an extended period of time with the air flow blades pointed downwards. Condensation may generate due to the difference in temperature.
Remote control is not working.	<ul style="list-style-type: none">• Check if your batteries are depleted.• Make sure batteries are correctly installed.• Make sure nothing is blocking your remote control sensor.• Check that there are strong lighting apparatus near the Product. Strong light that comes from fluorescent bulbs or neon signs may interrupt the electric waves.

Operation Ranges

The table below indicates the temperature and humidity ranges the Product can be operated within. Refer to the table for efficient use.

MODE	OPERATIONAL TEMPERATURE		INDOOR HUMIDITY	IF OUT OF CONDITIONS
	INDOOR	OUTDOOR		
COOLING	64 °F ~ 90 °F (18 °C to 32 °C)	Depends on the specifications of the outdoor unit.	80 % or less	Condensation may occur on the indoor unit with risk to have either water blow off or drops on the floor.
HEATING	81 °F (27 °C) or less		-	Internal protection triggers and the Product will stop.
DRYING	64 °F ~ 90 °F (18 °C to 32 °C)		80 % or less	Condensation may occur on the indoor unit with risk to have either water blow off or drops on the floor.

NOTE

- The standardized temperature for heating is 45 °F (7 °C). If the outdoor temperature drops to 32 °F(0 °C) or below, the heating capacity can be reduced depending on the temperature condition.
- If the cooling operation is used at over 90 °F (32 °C) (indoor temperature), it does not cool at its full capacity.



Register Product to Receive enhance warranty and view product documentation :
<https://www.warrantyourway.com/>

COUNTRY	CALL	OR VISIT US ONLINE AT
AMERICA	800-953-6669	www.lennox.com for homeowners, www.lennoxpros.com for dealer/contractor



DB68-12996C-00