

PACKAGED UNITS KITS AND ACCESSORIES

506560-02
1/2025
Supersedes 4/2021

RETURN AIR ADAPTER KIT

INSTALLATION INSTRUCTIONS FOR RETURN AIR ADAPTER KIT (54W96) USED WITH LG/LC/LH/LD/KG/KC/KH/KD 078-152 UNITS

⚠ WARNING

Improper installation, adjustment, alteration, service or maintenance can cause property damage, personal injury or loss of life. Installation and service must be performed by a licensed professional HVAC installer or equivalent, service agency, or the gas supplier.

Shipping and Packing List

Package 1 of 1 contains the following:

- 1- Return air adapter
- 2- #10 sheet metal screws

Application

Return air adapter is used to reduce the size of the return air opening, when necessary, in LG/LC/LH/LD/KG/KC/KH/KD 078-152 units.

Installation

⚠ CAUTION

As with any mechanical equipment, contact with sharp sheet metal edges can result in personal injury. Take care while handling this equipment and wear gloves and protective clothing.

Units without Fresh Air Accessories

- 1 - Remove three top screws and three bottom screws from fresh air access panel. Remove panel.
- 2 - Position adapter plate in return air opening as shown on label affixed to plate. Positioning label should face up. Secure plate using provided screw(s).

Units with Gravity Exhaust Damper and/or Power Exhaust Fan

NOTE – When installed, gravity exhaust damper and/or power exhaust fan must be removed in order to install return air damper.

- 1 - Disconnect all electrical power to unit.
- 2 - If applicable, remove six screws which secure gravity exhaust hood to unit.
- 3 - Remove two screws which secure gravity exhaust damper to unit. Carefully, remove dampers from unit and set aside.
- 4 - Remove three screws which secure power exhaust fan to unit. Ease power exhaust fan assembly out of unit and disconnect PEF power harness.

NOTE – Power exhaust fan cannot be completely removed and set aside until it is unplugged.

- 5 - Position adapter plate in return air opening as shown below. Positioning label should face up. Secure plate using provided screw(s).
- 6 - Reinstall components in reverse order and restore electrical power to unit.

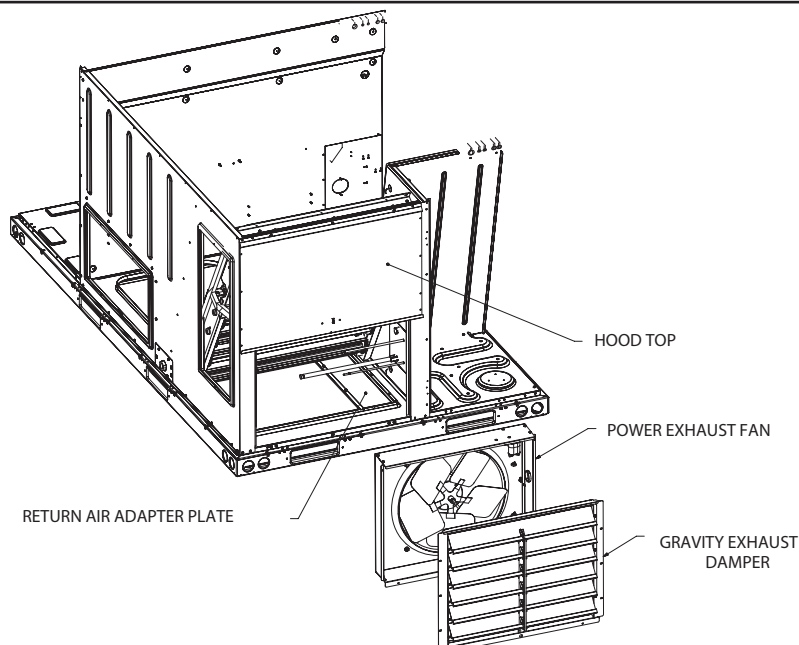

FIGURE 1