



©2024 Lennox Industries Inc.
Dallas, Texas, USA

AIR CLEANERS / FILTERS

508495-01
08/2024

PureAir™ S
Air Purification System

INSTALLATION INSTRUCTIONS FOR PCO3S Sensor Assembly Replacement Kit (27P27)

Shipping and Packing List

Check parts for shipping damage. If damage is found, immediately contact last carrier.

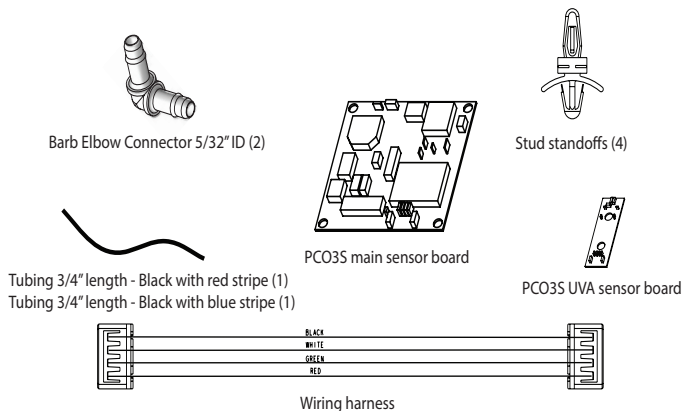

Figure 1. Parts Identification

Affected Models

Table 1. Unit Catalog Numbers

Model	Catalog Number
PCO3S-14-16	Y8905
PCO3S-16-16	Y8904
PCO3S-20-16	Y8903

Application

This instruction is for the field replacement of both the main sensor and UVA lamp sensor boards along with replacement standoffs, elbow connectors, tubing and wiring harness.

CAUTION

Sharp edges hazard.
Sharp edges can cause injuries.
Use protective gloves when grasping equipment edges.

Main Sensor Control Board

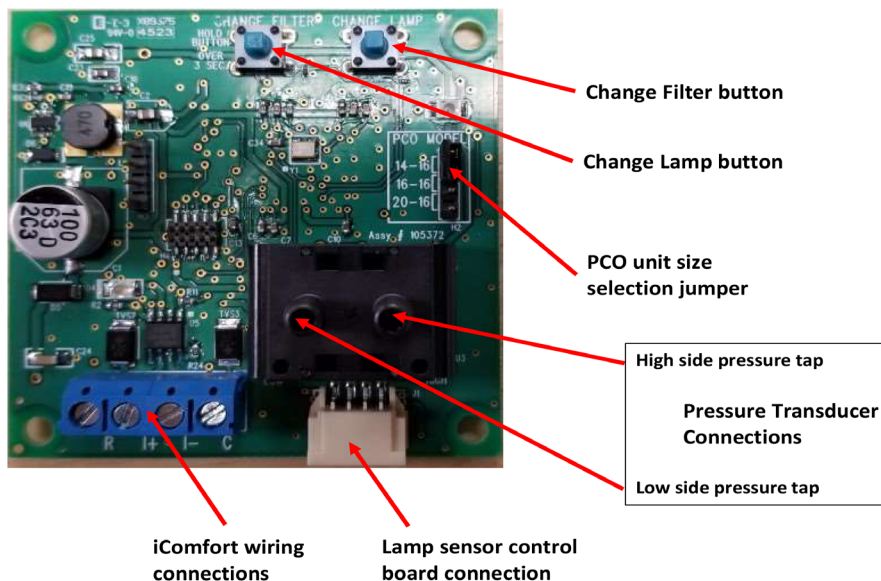

Figure 2. Main Sensor Board Connections

⚠ WARNING

Electric shock hazard.

Can cause injury or death.

Disconnect all electrical power supplies before servicing.
Access panels must be in place during appliance operation.

Main Sensor Control Removal and Replacement

IMPORTANT

Anytime a PCO3S sensor is replaced, the main sensor control **MUST** be replaced as well.

1. Disconnect power to the PCO3S unit.
2. Remove the access panel.
3. Locate the existing main sensor board.
4. Disconnect the wiring harness that goes to the UVA sensor board.
5. Disconnect the power and communication wiring.
6. Cut the tubing from the pressure transducer connections near the barb fitting of the elbow as illustrated below.

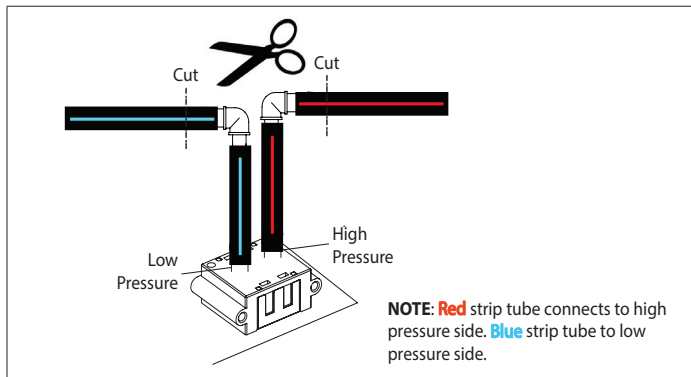

Figure 3. Cut Tubing

NOTE: Confirm which tubing is connected to which transducer connector. One has a red and the other a blue strip.

8. Remove and replace the control from the unit.

NOTE: Take note of the jumper setting for the PCO model. The jumper must have the same setting on the new main sensor board.

9. Reconnect the wiring harness to the UVA sensor board.
10. Reconnect the power and communication wiring.
11. Set the PCO filter size jumper. Use the same jumper position as the one on the removed control.

12. Use the kit provided tubing between the pressure transducer connections and the provided elbow. Then connect existing tubing to the elbow connectors.

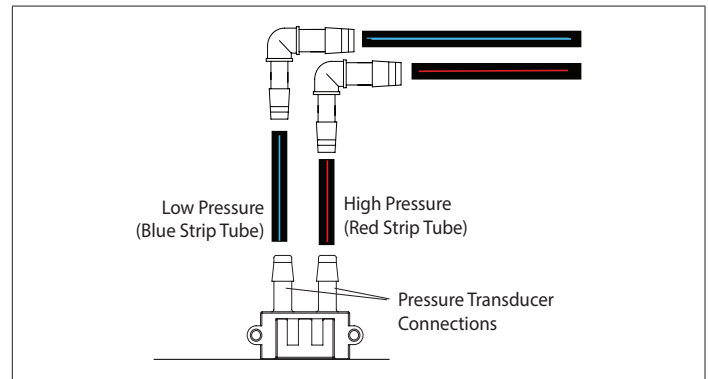

Figure 4. Reattach Tubing for Pressure Transducer Connections

UVA Sensor Control Removal and Replacement (If Required)

This procedure is provided only if it has been determined that the UVA sensor control requires replacement.

1. Turn 24VAC power off to main sensor board.

NOTE: Disconnecting 115VAC plug does not remove power to control.

2. Disconnect the wiring harness from the existing UVA sensor control board.
3. Remove the nuts and spacers from mounting studs
4. Using a small screw driver gently insert screw driver between control board and cabinet and gently pry control board loose from studs being careful not to loosen the spacer between UVA sensor control board and cabinet.
5. Replace UVA sensor control board and reinstall spacers, nuts, and harness.
6. Supply power (24VAC) to main the sensor board.
7. Reset the purifier button on the control by holding the button on the control board for five seconds. It can also be reset in the S30/S40 thermostat interface.