

# Single Wi-Fi Kit

# User & Installation manual

---

**VSTAT08P-1**

---

- Thank you for purchasing this Lennox Product.
- Before operating this unit, please read this manual carefully and retain it for future reference.

# Contents

---

<b>Safety precautions</b>	<b>3</b>
Safety precautions	3
<b>Checks before Installation</b>	<b>5</b>
Checks before Installation	5
Accessories • External Dimensions	5
<b>Installing the Single Wi-Fi Kit</b>	<b>6</b>
Installing the Single Wi-Fi Kit	6
4-Way Cassette (V1V33D01CPW)	6
4-Way (2x2) Cassette (V1V22D01CPW)	8
1-Way Cassette (V1VOWD03CPW / V1VOWD04CPW / V1VOWD05CPW)	10
360 Cassette (V1V36D01CPW / V1V36D01CPB / V1V36D02CPW / V1V36D02CPB)	12
<b>SmartThings app</b>	<b>15</b>
SmartThings app	15
Checking the power connections •	15
Setting up and connecting to a Wi-Fi access point using your smartphone •	
Downloading the SmartThings app and registering your Samsung account	
Connecting the SmartThings app to your product	16
<b>Appendix</b>	<b>17</b>
Troubleshooting	17
Specifications	18
Open Source Announcement	19
Regulatory Notice	20

# Safety precautions

---

California Proposition 65 Warning (US)

---

 **WARNING:** Cancer and Reproductive Harm - [www.P65Warnings.ca.gov](http://www.P65Warnings.ca.gov).

This installation manual explains how to install a Single Wi-Fi Kit to an indoor unit of Lennox. Read the installation manual thoroughly before installing the Single Wi-Fi Kit. (Refer to the appropriate manual for installing product or other optional parts.)

 **WARNING**

Hazards or unsafe practices that may result in severe personal injury or death.

 **CAUTION**

Hazards or unsafe practices that may result in minor personal injury or property damage.

 **WARNING**

**Contact service center for installation.**

- There is a risk of product malfunction, water leakage, electric shock or fire.

**Install the product securely in a place that can withstand the weight of the product.**

- If the installation location is not strong enough, product may fall and be damaged.

**Connect the power with rated voltage when installing.**

- If not, there is risk of fire or damage to the product.

**Do not attempt to move or re-install the product that is already installed.**

- There is risk of electric shock and fire.

**Do not attempt to modify or repair the product on your own.**

- There is potential risk of product damage, electric shock or fire. When repair is needed, consult service center.

**Check if the installation was done properly according to the installation manual.**

- If the product is installed incorrectly, there is risk of electric shock or fire.

**Make sure that all wiring work is done by a qualified person complying with regional standards and instructions in this manual.**

- If the installation is done by unqualified person, there is risk of product malfunction, electric shock or fire caused by incorrect installation.

**Contact the service center if you need to dispose the product.**

# Safety precautions

---

## CAUTION

**Do not install the product in a place where it is or might be exposed to inflammable gas leakage.**

- There is risk of fire or explosion.

**Do not install the product in a place where it will be exposed to oil or vapor etc.**

- If the product is used in a place where it is exposed to oil, vapor or sulphur dioxide, parts of the product may get damaged or product may function abnormally.

**Make sure that water does not get into the product.**

- There is risk of electric shock and fire.

**Make sure there is no tension to the cable during installation.**

- Cable may get cut and cause fire.

**Install the product in a place with temperature between 0 °C~39 °C (32 °F~102 °F) with no direct sunlight.**

- If not, there is risk of electric shock or abnormal operation.

**Do not install the product in a place where special spray or acid/alkali solution is used.**

- There is risk of electric shock or abnormal operation.

**Do not press the buttons with sharp objects.**

- There is risk of electric shock or damaging the parts.

**Do not connect the power cable to the communication cable terminal.**

- There is risk of fire.

**When installing the product in hospitals or other places, make sure that the product does not interrupt with other products.**

- Abnormal operation may occur.

**This wireless device has a possibility of radio wave interference during operation.**

# Checks before Installation

## Accessories

Single Wi-Fi Kit - with WIRE	Single Wi-Fi Kit CASE(360 Cassette)	User Manual / Installation Manual
		

### CAUTION

- The Single Wi-Fi Kit must be installed by a certified technician.
- Before installation, be sure to cut off power.
- Install the cables of the Single Wi-Fi Kit inside the product to prevent user access, in accordance with the relevant electrical wiring regulations.

## External Dimensions

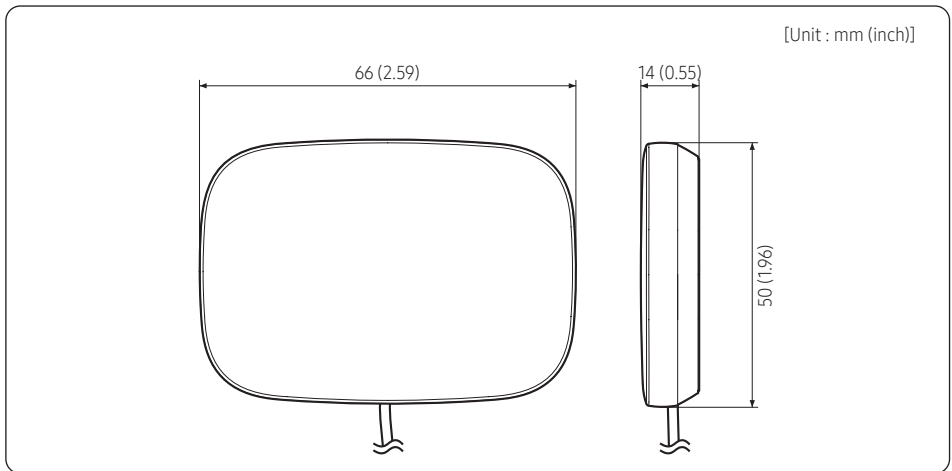

# Installing the Single Wi-Fi Kit

## 4-Way Cassette (V1V33D01CPW)

### Where to install

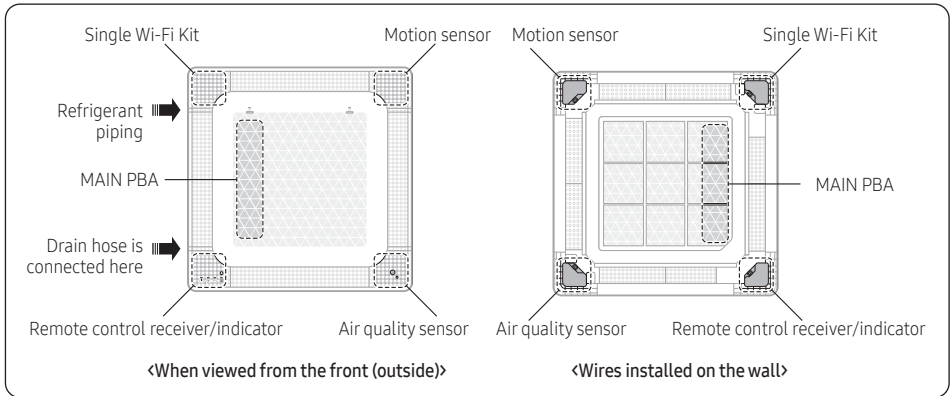

### ⚠ CAUTION

- If it is not installed at the specified position, communication interference or failure may occur. Make sure to install it at the specified position.
- If the panel is already installed on the indoor unit, first remove the panel from the indoor unit before installing the Single Wi-Fi Kit.  
For details on how to remove the panel, refer to the panel installation manual.

## Attaching the Single Wi-Fi Kit

- 1 After separating the corner panel, use the double-sided tape attached to the inside of the Single Wi-Fi Kit and fix it to the corner panel indentation.
  - Arrange the wire in the direction of the arrow of the indentation.

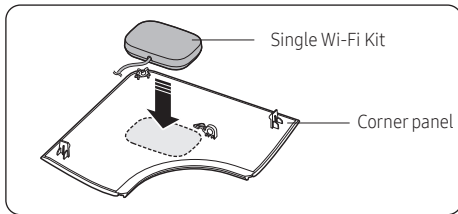

- 2 Arrange the wiring as follows.
  - a Unfasten the single screw (①) on the back cover.
  - b Lift up the back cover in the arrow direction (②), as shown in the figure.

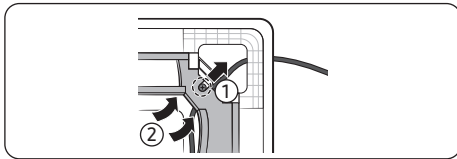

- c Arrange the wiring so that it is placed under the back cover when the cover is in place.
- d Tidy up the WIRE of the Single Wi-Fi Kit along the inside of the panel.
- e Attach the back cover.

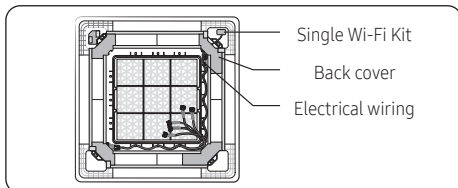

## ⚠ CAUTION

- The WIRE may get damaged if it is pinched between the back cover and the panel main body when attaching the back cover. Exercise caution to ensure that the WIRE is not pinched.
  - When attaching the back cover, fix the panel insulation to the original position.
- 3 Attach the panel to the indoor unit. (For details on how to attach the panel, refer to the panel installation manual.)
  - 4 Open the electric unit cover on the indoor unit, and connect the WIRE of the Single Wi-Fi Kit to the 'WIFI' connector (yellow, 5-pin) at the top right.

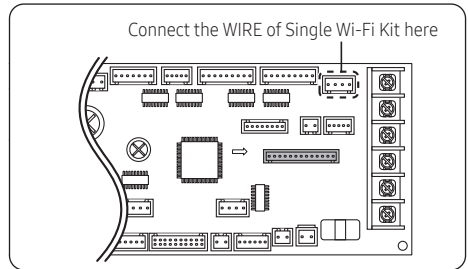

- 5 Close the electric unit cover on the indoor unit.

# Installing the Single Wi-Fi Kit

## 4-Way (2x2) Cassette (V1V22D01CPW)

### Where to install

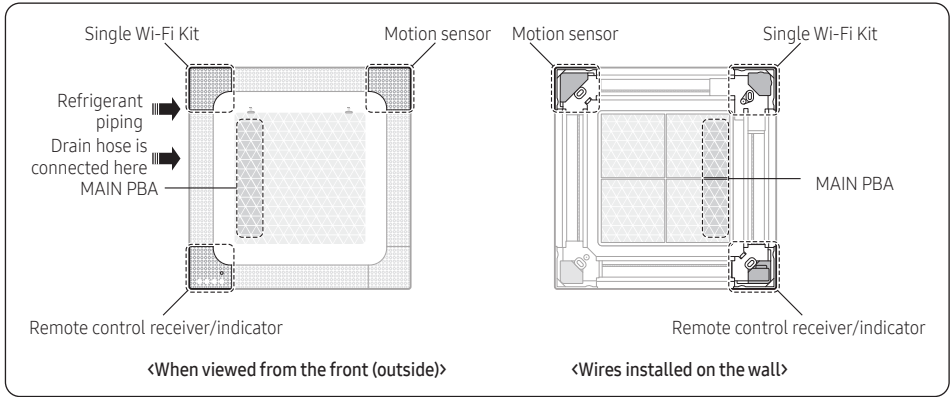

### ⚠ CAUTION

- If it is not installed at the specified position, communication interference or failure may occur. Make sure to install it at the specified position.
- If the panel is already installed on the indoor unit, first remove the panel from the indoor unit before installing the Single Wi-Fi Kit.  
For details on how to remove the panel, refer to the panel installation manual.

Installing the Single Wi-Fi Kit



## Attaching the Single Wi-Fi Kit

- 1 After separating the corner panel, use the double-sided tape attached to the inside of the Single Wi-Fi Kit and fix it to the corner panel indentation.
  - Arrange the wire in the direction of the arrow of the indentation.

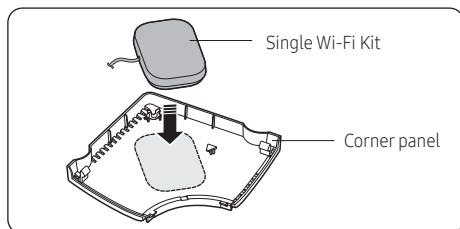

- 2 Arrange the wiring as follows.
  - a Unfasten the single screw (①) on the back cover.
  - b Lift up the back cover in the arrow direction (②), as shown in the figure.

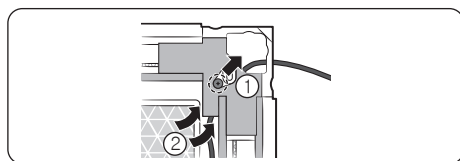

- c Arrange the wiring so that it is placed under the back cover when the cover is in place.
  - d Tidy up the WIRE of the Single Wi-Fi Kit along the inside of the panel.
  - e Attach the back cover.

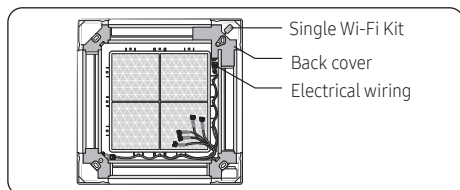

## ⚠ CAUTION

- The WIRE may get damaged if it is pinched between the back cover and the panel main body when attaching the back cover. Exercise caution to ensure that the WIRE is not pinched.
  - When attaching the back cover, fix the panel insulation to the original position.
- 3 Attach the panel to the indoor unit. (For details on how to attach the panel, refer to the panel installation manual.)
  - 4 Open the electric unit cover on the indoor unit, and connect the WIRE of the Single Wi-Fi Kit to the 'WIFI' connector (yellow, 5-pin) at the top right.

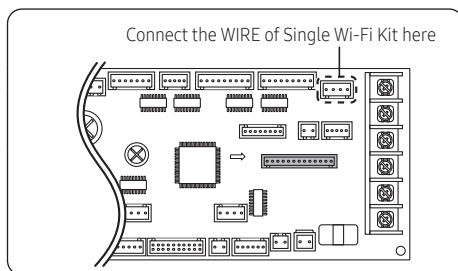

- 5 Close the electric unit cover on the indoor unit.

# Installing the Single Wi-Fi Kit

## 1-Way Cassette (V1VOWD03CPW / V1VOWD04CPW / V1VOWD05CPW)

### Where to install

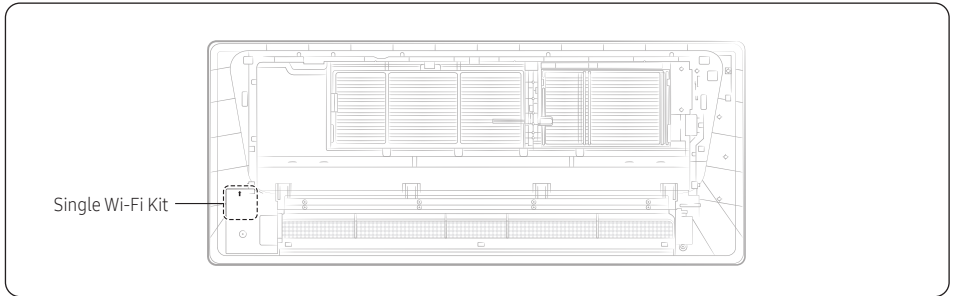

### CAUTION

- If it is not installed at the specified position, communication interference or failure may occur. Make sure to install it at the specified position.
  - If the panel is already installed on the indoor unit, first remove the panel from the indoor unit before installing the Single Wi-Fi Kit.
- For details on how to remove the panel, refer to the panel installation manual.

## Attaching the Single Wi-Fi Kit

- 1 Use the double-sided tape attached to the inside of the Single Wi-Fi Kit to fix it to the product's lower left indentation.
  - Arrange the wire in the direction of the arrow of the indentation.

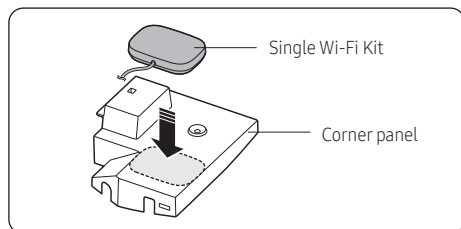

- 2 Tidy up the WIRE of the Single Wi-Fi Kit along the inside of the panel.

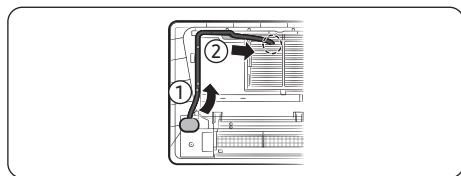

- 3 Attach the panel to the indoor unit.  
(For details on how to attach the panel, refer to the panel installation manual.)

- 4 Open the electric unit cover on the indoor unit, and connect the WIRE of the Single Wi-Fi Kit to the 'WIFI' connector (yellow, 5-pin) at the top right.

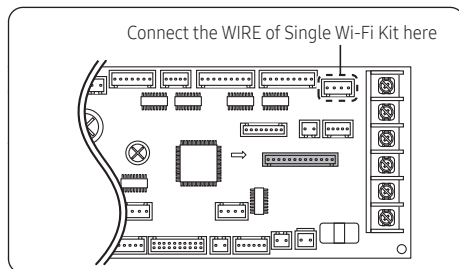

- 5 Close the electric unit cover on the indoor unit.

# Installing the Single Wi-Fi Kit

---

360 Cassette (V1V36D01CPW / V1V36D01CPB / V1V36D02CPW / V1V36D02CPB)

---

## Where to install

---

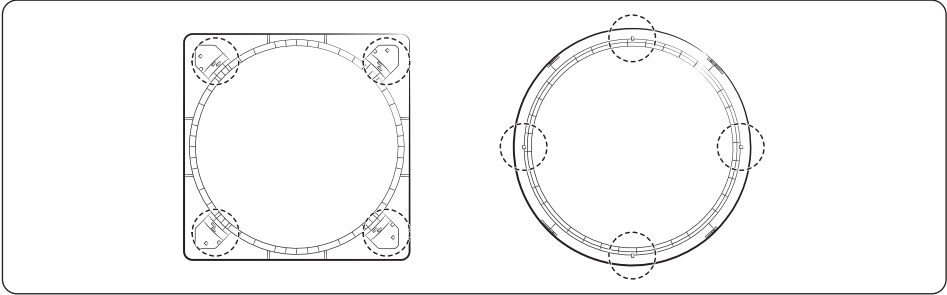

※ The 360 Panel (Circle/Square) can be installed in 4 different locations.

## Attaching the Single Wi-Fi Kit

- 1 Attach the Single Wi-Fi Kit to the CASE (①) enclosed.
  - a Before assembly, make sure the label attached to the bottom of the Single Wi-Fi Kit and the WIRE (②) are in contact with each other.

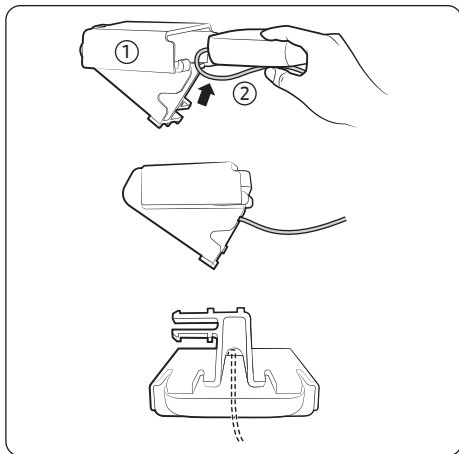

### ⚠ CAUTION

- Be careful that the Wire does not get pinched between the Case and the Single Wi-Fi Kit.
  - Make sure that the Wire is located at the centre of the space.
- 2 Arrange the WIRE so that it comes to the space on side of the CASE.

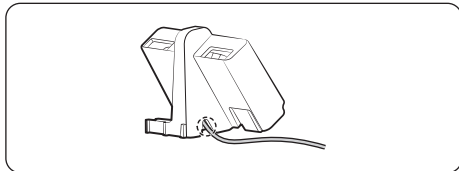

- 3 Fit the Case in the 360 Cassette panel.
  - a Fasten the HOOK (③) in the direction of the arrow as shown in the picture.
    - Square panel

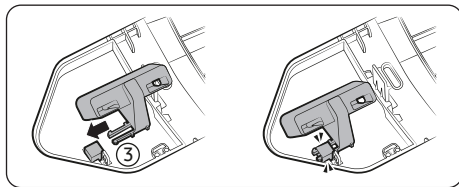

- Circle panel

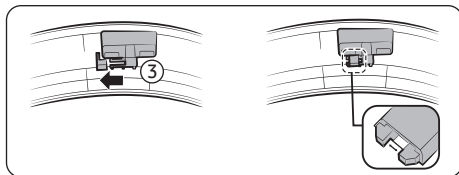

### ⚠ CAUTION

- Fix until the 'click' sound is heard.
  - Make sure that there is a gap in the edges of the Hook.
- 4 Attach the panel to the indoor unit. (For details on how to assemble the panel, refer to the panel installation manual.)
    - a Assemble the Single Wi-Fi Kit until it comes to the following location.

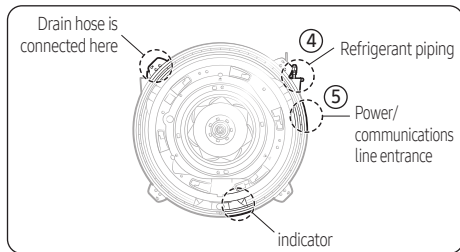

# Installing the Single Wi-Fi Kit

- Square panel: Assemble so that the Single Wi-Fi Kit comes to the Refrigerant piping(④) location of the indoor unit.

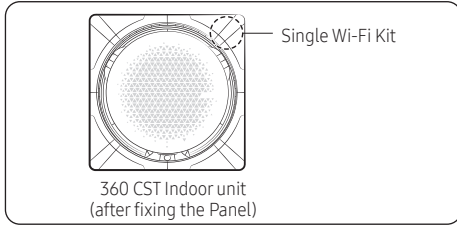

- Circle panel: Assemble so that the Single Wi-Fi Kit comes to the power/communications line entrance(⑤) of the indoor unit.

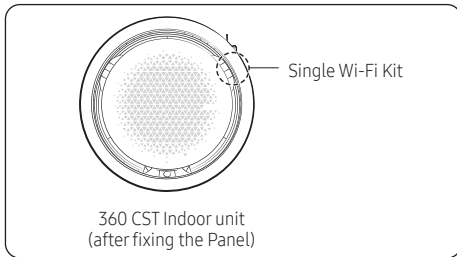

- b** Insert the Wire through the power/communications line entrance of the indoor unit and tidy up the wire in the space inside the indoor unit.

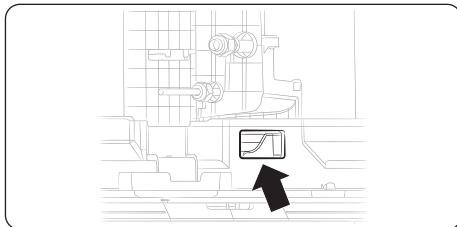

- 5** Open the insides of the electric equipment part of the indoor unit and connect the Wire of the Single Wi-Fi Kit to the "WiFi" connector (yellow color, 5-Pin).

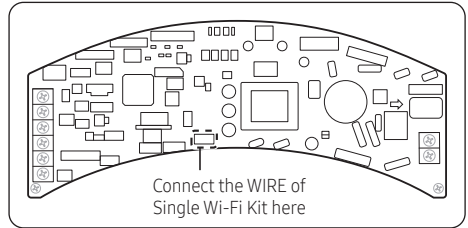

# SmartThings app

To use the SmartThings app, connect the product to the network in the sequence described below. The images shown may differ depending on your smartphone model, OS version and manufacturer. You need to set up the Wi-Fi access point only when connecting the product to a Wi-Fi network. Once the product is connected, you can use the SmartThings app via Wi-Fi, 3G, LTE or more wireless networks.

## 1 Checking the power connections

Check if the power is connected to the product and the access point.

## 2 Setting up and connecting to a Wi-Fi access point using your smartphone

1 To connect the product to a Wi-Fi network, turn on Wi-Fi at "Settings > Wi-Fi", and then select the access point to connect to

- Only alphanumeric characters are supported for wireless access point names (SSIDs). If an SSID has a special character, rename it before connecting to it.
- Wi-Fi access point: 2.4 GHz Wi-Fi access point only.



2 Turning off "SMART NETWORK SWITCH" at "Settings > Wi-Fi" on your Smartphone

- If "SMART NETWORK SWITCH" or "Adaptive Wi-Fi" is turned on, you cannot connect to the network. Be sure to turn off these functions before connecting to the network.



### NOTE

- The setup may differ depending on your smartphone model, OS version and manufacturer.

## 3 Checking the Internet connectivity

- After connecting to Wi-Fi, check that your smartphone is connected to the Internet.

### NOTE

- A firewall may prevent your smartphone from connecting to the Internet. In this case, contact your Internet service provider for troubleshooting.

## 3 Downloading the SmartThings app and registering your Samsung account

### 1 Downloading the SmartThings app

- Search for "SmartThings" on the Play Store or App Store, and download the SmartThings app to your smartphone.
- If the SmartThings app is already installed on your smartphone, update it to the latest version.

### NOTE

- The supporting software version of the SmartThings app is subject to change according to the OS supporting policy the manufacturer provides. In addition, as for the SmartThings app or the functions that the app supports, the new application update policy on the existing OS version can be suspended due to usability or security reasons.
- The SmartThings app is subject to change without notice to improve usability or performance. As the mobile phone OS version is updated every year, SmartThings is also updated continually according to the latest OS.
- If you have inquiries regarding the items mentioned above, please contact us at [st.service@samsung.com](mailto:st.service@samsung.com).

### 2 Registering your Samsung account

- A Samsung account is required to use the SmartThings app. To create your Samsung account and log in to your account, follow the instructions displayed on the SmartThings app. You do not need to install an additional app.

# SmartThings app

## NOTE

- If you already have a Samsung account, log in to the account. When your smartphone is a Samsung device and you have a Samsung account, your smartphone is automatically logged in to your account.
- If you log in from a smartphone produced for a different country, you need to log in with its country code when you create your Samsung account, and the SmartThings app may not be used on some smartphones.

## 4 Connecting the SmartThings app to your product

### 1 Selecting the product to connect to

- 1) After the SmartThings app is started, select "ADD NOW" when a pop-up window saying that a product to connect to is found appears.

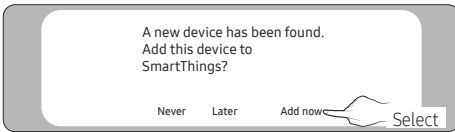

- 2) If the pop-up window does not appear, select "+", "Add" and then "Device".

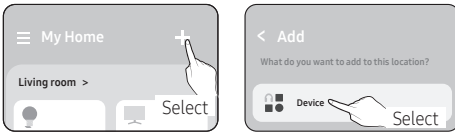

You can add a product you want to connect to by selecting it manually or by selecting "Scan nearby".

- Select manually: Partner devices > Lennox
- Scan nearby: Lennox System A/C

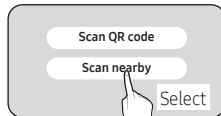
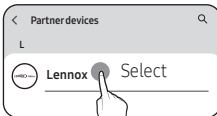

### 2 Connecting the SmartThings app to your product

- Follow the instructions displayed on the SmartThings app to connect to your product.
- If a message appears saying 'Press the [AP] button' while the connection is in progress, press and hold the [AP] button on the remote control (separately purchasable / model name: VSTAT01P-1) for more than 5 seconds.
- For information on how to use the SmartThings app, select the How To menu on the app.

## NOTE

- If any pop-up window appears on the top of the smartphone while connecting to your product, do not select it.
- If a Samsung account-related country error occurs while connecting to your product, log out of your current Samsung account, log in to your previous Samsung account, and then delete all devices that have been connected previously. Then, log in to your current Samsung account again, and configure the settings.
- If a failure message appears while adding a device, see "Setting up and connecting to a Wi-Fi access point using your smartphone" on page 15. The connection may fail temporarily due to an installation location problem of the access point or other problems.
- If the number of added indoor units is incorrect after adding devices, run the tracking again and then try adding the devices again.
- For security protocols for wireless/wired access points, WPA-PSK and WPA2-PSK are recommended. For authentication methods, AES is recommended. New Wi-Fi authentication specifications and Wi-Fi non-standard authentication methods are not supported.
- If your Internet service provider has permanently registered the MAC address (a unique identification number) of your PC or modem, you may not be able to connect your product to the Internet. Contact your Internet service provider and ask how to connect devices other than your PC (such as an air conditioner and an air purifier) to the Internet.



# Troubleshooting

Check the following before requesting a service from the Service Center.

Symptom		Measure
The installed SmartThings app cannot access the product.		<ul style="list-style-type: none"> <li>Make sure you have connected the product to a wireless router.</li> </ul>
I cannot log in with my Samsung account.		<ul style="list-style-type: none"> <li>Try recovering your ID and password from the Samsung account page.</li> </ul>
Adding device(s)	A failure message appears while adding devices.	<ul style="list-style-type: none"> <li>This may fail temporarily due to the distance from the router or some interferences. Try again later.</li> </ul>
	While adding the device, the progress stops at 0%-1% and a message appears saying that adding the device has failed.	<ul style="list-style-type: none"> <li>You cannot add any device without deleting it once the device has already been added to the SmartThings app. To add the connected device again, first remove it and then proceed with the process.</li> </ul>
	While adding the device, the progress is stuck at 99% and a message appears saying that adding the device has failed.	<ul style="list-style-type: none"> <li>If you are using a Samsung smartphone, the server may not be connected temporarily. Restart the SmartThings app and then try adding the device again.</li> <li>If your phone is not a Samsung product, check that you have entered a wrong Wi-Fi password. Try adding devices again.</li> </ul>
	The app displays an authorization failure before pressing the user agreement button.	<ul style="list-style-type: none"> <li>Check if a Single Wi-Fi Kit is already connected from the SmartThings app. When there are devices added, first remove them and try again.</li> </ul>
	The app displays an authorization failure on the user agreement screen.	<ul style="list-style-type: none"> <li>Make sure to press the [Power] button within 2 minutes after the screen appears. Try adding devices again.</li> </ul>
	The screen requests to initialize the user account.	<ul style="list-style-type: none"> <li>This happens when the user has already added devices. Follow the instructions provided in the SmartThings app.</li> </ul>
	After adding a device, the SmartThings app displays the disconnection event.	

# Specifications

---

Wi-Fi	
Frequency Range	Transmitter Power (Max)
2412 - 2472 MHz	17 dBm

\* The product supports the IEEE802.11 b/g/n, Soft-AP communication protocol.  
(Lennox recommends IEEE802.11n.)

# Open Source Announcement

---

The software included in this product contains open source software.

The following URL [http://opensource.samsung.com/opensource/SMART\\_TP1\\_0/seq/0](http://opensource.samsung.com/opensource/SMART_TP1_0/seq/0) leads to open source license information as related to this product.



# Regulatory Notice

---

## FCC Notice

---

### **FCC CAUTION:**

Any changes or modifications not expressly approved by the party responsible for compliance could void the user's authority to operate the equipment.

This appliance contains the transmitter module.

This device complies with Part 15 of FCC Rules. Operation is Subject to the following two conditions:

- (1) This device may not cause harmful interference, and
- (2) This device must accept any interference received including interference that cause undesired operation.

For products available in the US and Canadian markets, only channels 1-11 are available.

You cannot select other channels.

### **FCC STATEMENT:**

This equipment has been tested and found to comply within the limits for a Class B digital device, pursuant to part 15 of the FCC Rules. These limits are designed to provide reasonable protection against harmful interference in a residential installation.

This equipment generates, uses, and can radiate radio frequency energy and, if not installed and used in accordance with the instructions, may cause harmful interference to radio communications. However, there is no guarantee that interference will not occur in a particular installation. If this equipment does cause harmful interference to radio or television reception, which can be determined by turning the equipment off and on, the user is encouraged to try to correct the interference by one or more of the following measures:

- Reorient or relocate the receiving antenna
- Increase the separation between the equipment and receiver
- Connect the equipment to an outlet that is on a different circuit than the receiver.
- Consult the dealer or an experienced radio/TV technician for help.

### **FCC RADIATION EXPOSURE STATEMENT:**

This equipment complies with FCC radiation exposure limits set forth for an uncontrolled environment.

This equipment should be installed and operated so there is at least 8 inches (20 cm) between the radiator and your body. This device and its antennas must not be co-located or operated in conjunction with any other antenna or transmitter except in accordance with FCC multi-transmitter product procedures.

---

### FCC Compliance Statement (applicable models only)

Model	VSTAT08P-1
Variant Model	- (The symbol "*" can be any alphanumeric character.)
Responsible Party - U.S. Contact Information	Lennox International 2140 Lake Park Blvd, Richardson, TX 75080 Tel: 800-953-6669

This device complies with Part 15 of the FCC Rules. Operation is subject to the following two conditions: (1) This device may not cause harmful interference, and (2) This device must accept any interference received, including interference that may cause undesired operation.

### IC Notice

---

This appliance contains the transmitter module.

The term "IC" before the radio certification number only signifies that Industry Canada technical specifications were met. Operation is subject to the following two conditions : (1) this device may not cause interference, and (2) this device must accept any interference, including interference that may cause undesired operation of the device.

This Class B digital apparatus complies with Canadian ICES-003.

For products available in the US and Canadian markets, only channels 1~11 are available.  
You cannot select other channels.

### IC RADIATION EXPOSURE STATEMENT:

This equipment complies with IC RSS-102 radiation exposure limits set forth for an uncontrolled environment. This equipment should be installed and operated so there is at least 8 inches (20 cm) between the radiator and your body. This device and it's antennas must not be co-located or operated in conjunction with any other antenna or transmitter except in accordance with FCC multi-transmitter product procedures.

**SAVE THESE INSTRUCTIONS**

QUESTIONS OR COMMENTS?

COUNTRY	CALL	OR VISIT US ONLINE AT
AMERICA	800-953-6669	www.lennox.com for homeowners, www.lennoxpros.com for dealer/contractor