



©2023 Lennox Industries Inc.
Dallas, Texas, USA

**This manual must be left with the owner
for future reference.**

Shipping and Packing List

Package 1 of 1 contains:

- 1 – Wireless Controller
- 2 – AAA batteries
- 1 – Remote controller holder with mounting screw

Table of Contents

General.....	2
Requirements	2
Remote Controller Specifications	2
Handling the Remote Controller	2
Inserting and Replacing Batteries	2
Battery Disposal	3
Remote Controller Tips	3
FCC Compliance Statement	3
Buttons and Functions	4
Screen Icons.....	5
Basic Functions	6
Setting the Temperature.....	6
AUTO Mode	6
COOL Mode.....	6
DRY Mode	7
HEAT Mode.....	7
FAN Mode	8
Setting the TIMER.....	8
Advanced Functions	9

INSTALLATION AND USER INFORMATION GUIDE

Lennox Mini-Split Systems Indoor Wireless Programmable Controller (RG10F2-MMA)

CONTROLS

508415-01

9/2023

CAUTION

As with any mechanical equipment, contact with sharp sheet metal edges can result in personal injury. Use caution while handling this equipment. Wear gloves and protective clothing.

IMPORTANT

Frequent changes to operating mode may cause system malfunctions. Allow at least one minute between mode changes to allow the system to stabilize.

General

The RG10F2-MMA is a wireless programmable controller for the MLB/ MPC outdoor units with MMA indoor units. It is capable of executing timed schedules for daily operation. These instructions are intended as a general guide and do not supersede local codes in any way. Consult authorities having jurisdiction before installation.

Requirements

Verify the power supply has been turned off before beginning installation. This controller should be used only as described in this manual.

Do not install the controller on exterior walls (where there is unconditioned space on opposite side of wall) or in locations where direct sunlight may be present.

Remote Controller Specifications

Model	RG10F2-MMA
Rated Voltage	3.0V (Dry batteries, AAA)
Signal Receiving Range	26 feet (8 meters)
Environment	23°F~140°F (-5°C~60°C)

Handling the Remote Controller

Inserting and Replacing Batteries

1. Slide the back cover on the remote controller downward, exposing the battery compartment.
2. Insert the batteries; match the (+) and (-) ends of the batteries with the symbols inside the battery compartment.
3. Slide the battery cover back into place.

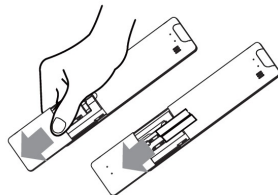

Figure 1. Removing Battery Cover

NOTE: For optimum product performance: Do not mix old and new batteries, or batteries of different types. Do not leave batteries in the remote controller if it will not be used for more than two months.

Battery Disposal

Do not dispose of batteries as unsorted municipal waste. Refer to local laws for proper disposal of batteries.

Remote Controller Tips

- The remote controller must be used within 26 feet (8 meters) of the unit.
- The unit beeps when remote signal is received.
- Curtains, other materials, and direct sunlight can interfere with the infrared signal receiver.
- Remove batteries from the remote controller if it will not be used for more than two months.

FCC Compliance Statement

This device complies with Part 15 of the FCC Rules. Operation is subject to the following two conditions:

1. This device may not cause harmful interference.
2. This device must accept any interference received, including interference that may cause undesired operation.

NOTE: *This equipment has been tested and found to comply with the limits for a Class A digital device, pursuant to Part 15 of the FCC Rules. These limits are designed to provide reasonable protection against harmful interference when the equipment is operated in a commercial environment. This equipment generates, uses, and can radiate radio frequency energy, and if it is not installed and used in accordance with the instruction manual, it may cause harmful interference to radio communications.*

Operation of this equipment in a residential area is likely to cause harmful interference, in which case the user will be required to correct the interference at their own expense.

MODIFICATIONS:

Any modifications made to this device that are not approved by Lennox International may void the authority granted to the user by the FCC to operate this equipment.

Buttons and Functions

The following is a brief overview of the remote controller. For instructions on how to operate the unit, see "Basic Functions" on page 6 of this manual.

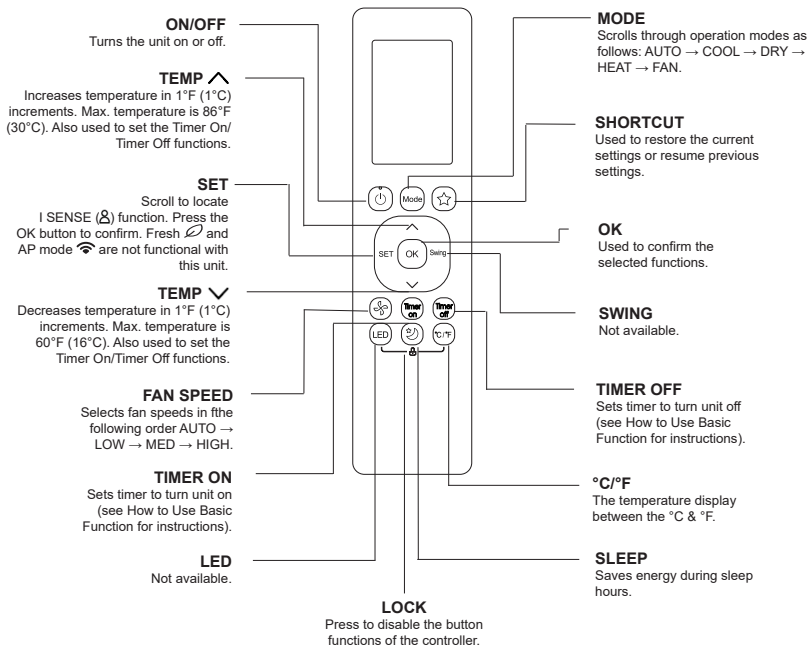

Figure 2. Controller Buttons and Functions

Screen Icons

The following icons display after powering up the remote controller.

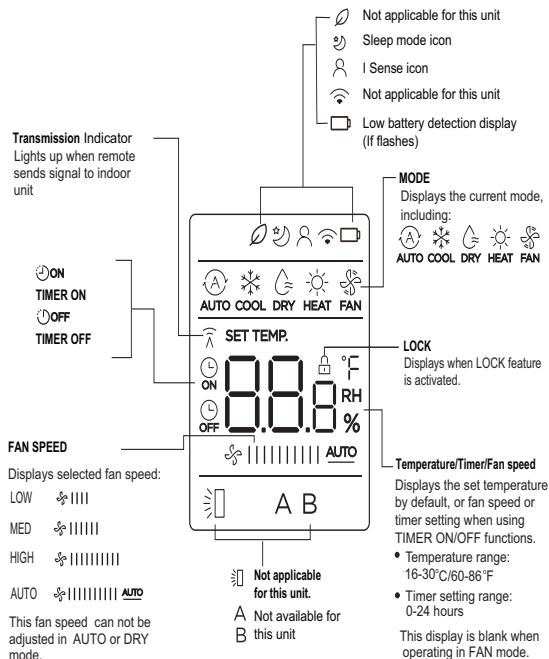

Figure 3. Remote Controller Screen Icons

NOTE: All icons shown in Figure 3 are for display purposes only. Only active icons display during unit operation.

Basic Functions

Before operation, verify the unit is powered up.

Setting the Temperature

The operating temperature range for units is 60-86°F (16-30°C).

Users can increase or decrease the set temperature in 1°F (1°C) increments.

AUTO Mode

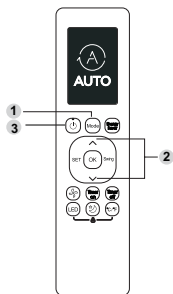

In AUTO mode, the unit will automatically select the COOL, FAN, or HEAT function based on the set temperature.

1. Press the MODE button to select AUTO.

2. Set the target temperature using the TEMP \wedge or TEMP \vee button.
3. Press the ON/OFF button to start the unit.

NOTE: FAN SPEED cannot be set in AUTO mode.

COOL Mode

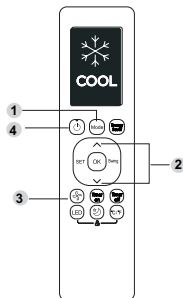

1. Press the MODE button to select COOL mode.
2. Set the target temperature using the TEMP \wedge or TEMP \vee button.
3. Press FAN button to select the fan speed: AUTO, LOW, MED, HIGH.
4. Press the ON/OFF button to start the unit.

DRY Mode

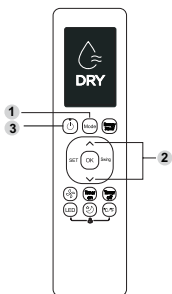

1. Press the MODE button to select DRY.
2. Set the target temperature using the TEMP \wedge or TEMP \vee button.
3. Press the ON/OFF button to start the unit. *FAN SPEED cannot be changed in DRY mode.*

HEAT Mode

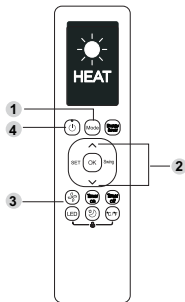

1. Press the MODE button to select HEAT mode.
2. Set the target temperature using the TEMP \wedge or TEMP \vee button.
3. Press FAN button to select the fan speed: AUTO, LOW, MED, HIGH
4. Press the ON/OFF button to start the unit.

NOTE: *As outdoor temperature drops, the performance of the unit's HEAT function may be affected. In such instances, Lennox recommends using this unit in conjunction with other heating appliances.*

FAN Mode

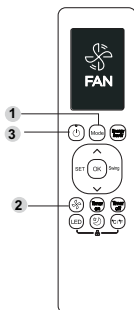

1. Press the MODE button to select FAN mode.
2. Press FAN button to select the fan speed: AUTO, LOW, MED, HIGH.
3. Press the ON/OFF button to start the unit.

NOTE: The temperature can not be set while in FAN mode. As a result, your remote controller's LCD screen will not display temperature.

Setting the TIMER

TIMER ON

1. Press TIMER ON to initiate the ON time sequence.

2. Press the TEMP \wedge or TEMP \vee button to set the start time for the unit.
3. Point the remote controller toward the unit and wait for one second. The TIMER ON function is set.

TIMER OFF

1. Press TIMER OFF to initiate the OFF time sequence.
2. Press the TEMP \wedge or TEMP \vee button to set the end time for the unit.
3. Point the remote controller toward the unit and wait for one second. The TIMER OFF function is set.

NOTE: When setting the **TIMER ON** or **TIMER OFF**, the time will increase by 30 minutes increments with each press, up to 10 hours. After 10 hours and up to 24 hours, it will increase in 1 hour increments. (For example, press 5 times to get 2.5h, and press 10 times to get 5h. The timer will revert to 0.0 after 24.) Cancel either function by setting its timer to 0.0h.

To Cancel TIMER ON/TIMER OFF

Cancel either function by setting the timer to 0.0h.

Advanced Functions

- **SWING**
Not applicable for this unit.
 - **SHORTCUT**
Press Shortcut and the system automatically reverts to the previous settings (including Operating Mode, Setting Temperature, Fan Speed Level, and Sleep Feature, if set).
- NOTE:** *If the **Shortcut** button is pressed for longer than two seconds, the system automatically restores the current operation settings.*
- **°C/°F**
Press °C/°F to alternate the temperature display between celcius and fahrenheit.
 - **LED Display**
Press the LED button to turn on and off the LED display on the indoor unit.
 - **SLEEP**
Press the Sleep button to decrease the unit's energy usage. This function is beneficial for users who do not require the same temperature settings to stay comfortable while sleeping. Only the remote controller can activate the Sleep function.
- NOTE:** *The Sleep function is not available in FAN or DRY mode.*
- **LOCK**
Press LED and °C/°F simultaneously for five seconds to activate the Lock function. Once locked, all buttons lose functionality. To restore functionality, press LED and °C/°F simultaneously for two seconds.
 - **SET**
Press the SET button to enter the function setting. Press SET, TEMP \wedge or TEMP \vee to select the target function. The selected symbol will flash on the display area, press the OK button to confirm.

To cancel the selected function, press SET, TEMP \wedge or TEMP \vee to locate the function to cancel. After locating the system function, press OK to cancel it.
 - **I SENSE**
Enables the remote controller to measure the temperature at its current location and send this signal to the unit every three minutes. When using AUTO, COOL or HEAT modes, measuring ambient temperature from the remote controller (instead of from the indoor unit itself) enables the unit to optimize the temperature to ensure maximum comfort.

