

Job: _____
Location: _____
Schedule No.: _____
System Designation: _____

Engineer: _____
Architect: _____
Location: _____
Date: _____

Low Ambient Heat Pump

For: Reference Approval Review Construction

FEATURES

- 100% capacity at -22°F
- Advanced flash injection technology
- Low ambient cooling
- Low ambient heating
- Simplified chassis design and integral inverter check function
- Artificial intelligence (AI) technology
- Zoning solution
- Cooling solution

WARRANTY

- Compressor - 10-year limited warranty
 - All other components - 10-year limited warranty
- *See warranty for details

SPECIFICATIONS

PERFORMANCE

Cooling Capacity ¹ (Btu/h)	Nominal	72,000
	Rated ²	69,000
EER	Ducted	12.7
	Non-Ducted	13.1
IEER	Ducted	23.7
	Non-Ducted	28.3
Heating Capacity ¹ (Btu/h)		81,000
COP47/COP17	Ducted	4.14/2.46
	Non-Ducted	4.30/2.58
Operating Temperatures (°F)	Cooling	5-122
	Heating	-22-75

ELECTRICAL DATA

Power Supply (Volts/Phase/Hertz)	460/3/60
Minimum Circuit Ampacity (A)	25.0
Maximum Overcurrent Protection (A)	30
Number of Compressors	2
Outdoor Fan FLA (A)	2.1/2.1

GENERAL DATA

Connection Ratio ³	50% to 184%
Maximum Number of Indoor Units	12
Refrigerant Type	R-410A
Factory Refrigerant Charge (each unit)	17.6 lbs.

NOTES

1. Cooling and Heating capacity data is rated at the following conditions:
 Cooling: 80°FDB / 67°FWB Indoor, 95°FDB Outdoor
 Heating: 70°FDB Indoor, 47°FDB / 43°FWB Outdoor
2. Certified in accordance with the AHRI Variable Refrigerant Flow Multi-Split Air-Conditioners and Heat Pump (VRF) Certification Program which is based on the latest edition of AHRI Standard 1230-2021.
3. Restrictions apply. Refer to the VRF Engineering Handbook for full details.



DIMENSIONS (Each Module)

Unit	Height	66-3/4
Dimensions (in)	Width	51
	Depth	30-1/8
Net Weight		571
Main System Piping (in)		
Liquid Pipe Connection		3/8
Gas Pipe Connection		3/4



DIMENSIONAL DRAWINGS - MM (Inches)

Section B-B

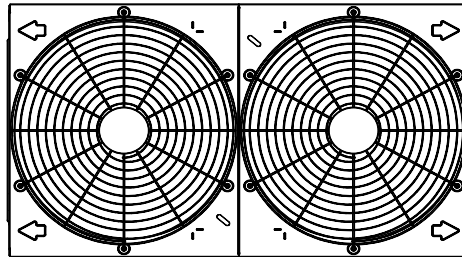
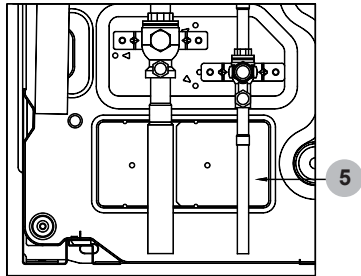

Detail A

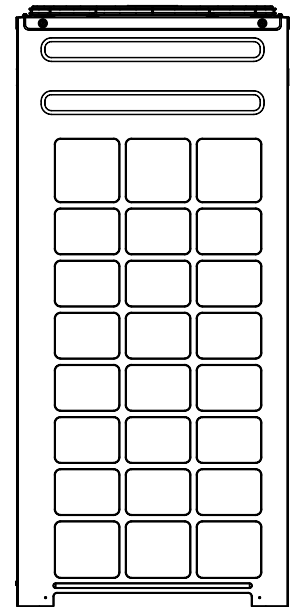
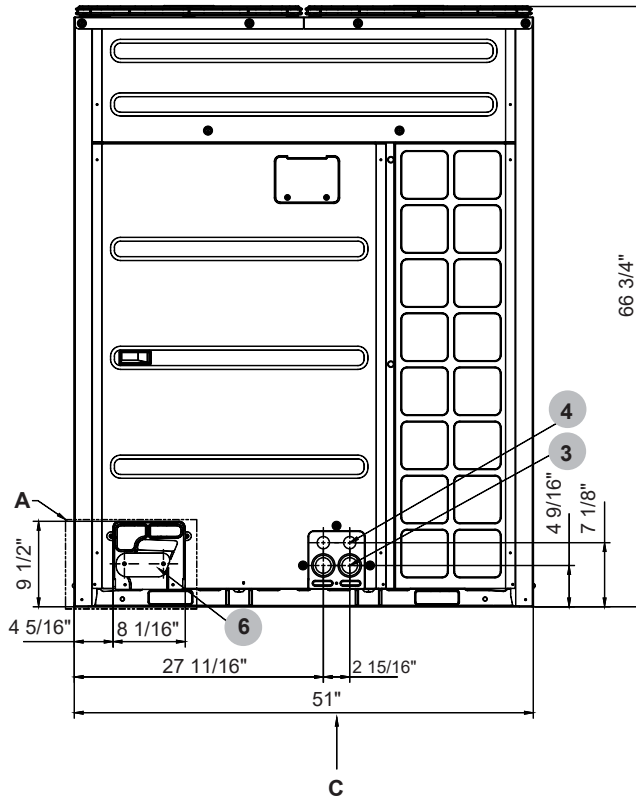
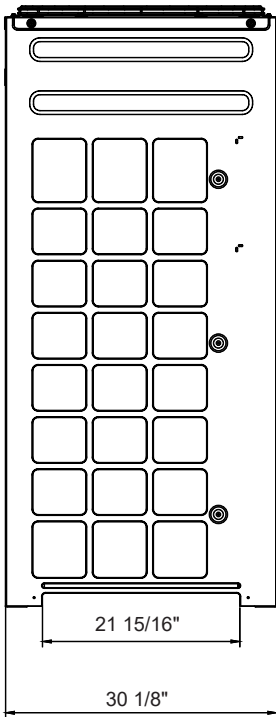
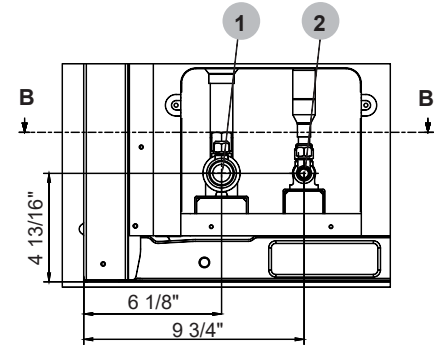

Notes

1. Detail A and SECTION B-B indicate the dimensions after connecting piping
2. View C indicates knockout hole dimensions (bottom)

No.	Description	Remark
1	Gas refrigerant pipe	3/4"
2	Liquid refrigerant pipe	3/8"
3	Power conduit knockout	1 3/4"
4	Communication wire knockout	1 3/8"
5	Knockout for refrigerant piping	Bottom
6	Knockout for refrigerant piping	Front

View C

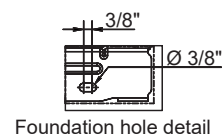
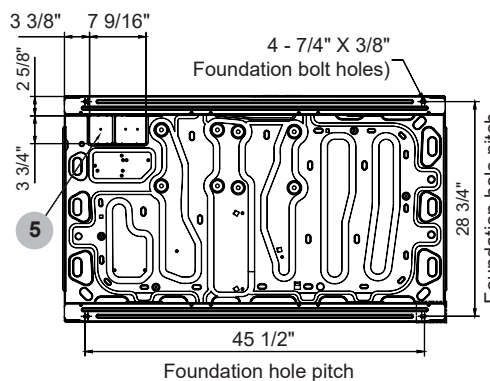

NOTE - Due to Lennox' ongoing commitment to quality, Specifications, Ratings and Dimensions subject to change without notice and without incurring liability. Improper installation, adjustment, alteration, service or maintenance can cause property damage or personal injury. Installation and service must be performed by a qualified installer and servicing agency.